

37 Seville Pilothouse

Equipment List

January 2007

LOA: 37' 2", Length Waterline: 34' 6", Beam: 13' 11", Draft: 4' 0", Displacement: 24,500 lbs, Fuel: 300 Gal, Water: 140 Gal

Deck, Bridge, Cockpit & Hull

- Anchor Locker
- Stainless steel Bow Rail
- Bridge seating with storage underneath
- Bow, stern and spring cleats
- Cockpit storage
- Compass
- Cockpit and bridge deck courtesy Lights
- Anchor pulpit
- FRP swim platform
- Taco rub rail
- One Opening windshield
- Windshield wiper
- Hardtop hatch and forward cabin hatch
- Sliding companionway door
- Solid laminate hull with vinylester resins in external layers and fitted with internal FRP grid
- Navigation lights

Mechanical Equipment

- Standard Engine: 135-hp diesel
- Engine Options: Single 220 to 440-hp or Twin 135 to 315-hp
- Freshwater cooling on engine
- Engine alarm system
- Racor fuel filter
- Two 150-gal FRP fuel tanks
- Stainless steel propeller shaft(s)
- Stuffing Box: PYI Dripless or equivalent
- Bronze propellers
- Full Keel, stainless steel rudder, rudder shoe with single engine
- Hot and cold pressurized water
- Manual bilge pump
- Bronze sea strainer
- Seacocks on underwater thru-hull fittings

Electrical Equipment

- Paneltronics AC/DC service panel
- Cole-Hersee battery selector switch and engine battery cutoff switch
- Marinco shore power inlet
- 12v electrical outlets in salon and bridge
- Four 110v electrical outlets
- 12v electric lights: 8-main salon with switch next to aft door, 2-forward cabin, under berth lighting, 1-head, 1-shower, 6-engine room, 1-aft deck, 2-Lazarette

- GFCI protection
- Color-coded wiring harness
- Three 4D batteries with single engine, four 4D batteries with twin
- Guest by Marinco 40-amp battery charger
- Marine Hot Water Heater
- Bonding systems with zinc anode
- Two Rule bilge pumps with Rule-a-matic switches
- Jabsco fresh water pump

Helm

- Two Morse controls
- Two instrument control centers
- Stainless wheel
- Sea Star steering system

Galley

- Seaward Princess electric stove top
- Dual electric refrigerator/freezer
- Sink
- Designer faucet
- Two 65-gal stainless steel water tanks
- Cabinets
- Formica countertops (Standard)
- Dupont/corion/marble/granite...countertops (Optional)

Head

- Jabsco head
- 30-gal FRP holding tank
- Separate shower stall
- Shower sump pump
- Built-in vanity
- Mirror

Fittings

- Southco Door hardware
- Manship 24-inch x 24-inch stainless steel hatches
- Manship stainless steel port holes

Additional Outfitting

- Anchor
- Dock lines
- Electric horn
- Flare Kit
- Fire extinguishers (2)
- Life vests
- Type IV throw-able personal floatation device

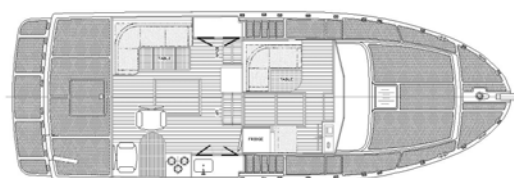
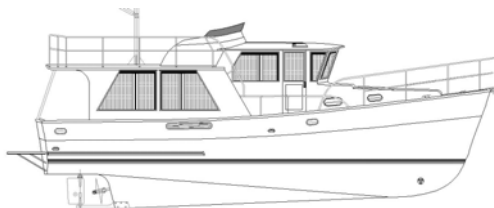

Data provided in this document is for informational purposes only. Neither manufacturer nor its agents make any claims to the accuracy of the data contained herein notwithstanding the fact that said data is true to the best of the manufacturer's knowledge. First World Yacht, Ltd. reserves the right to change without notice any materials, specifications, equipment, pricing and/or accessories.